

selecting replacement hydraulic steering

Helm Mounting Options & Tilt Steering

SeaStar offers a variety of helm mounting options to accommodate nearly any preference. These options are available for all helms, except Capilano and Hynautic helms. Please take a moment to familiarize yourself with these options before ordering replacement steering systems or components.

Helm Mounting Options:

SeaStar hydraulic steering helms typically mount on the dash surface with the steering shaft at 90° to the dash. A SeaStar rear mount helm is also available for concealed (behind the dash) mounting. Capilano and Hynautic helms are available in only one mounting style: behind the dash at 90°.

Optional kits are available to reduce SeaStar helm protrusion from the dash, use, or cover dash holes left by steering key systems previously installed on the boat.

The Round Bezel Kit (HA5417) reduces SeaStar helm protrusion from the front of the dash by 3.75". (Not for BayStar.)

The Backplate kit (HA5418) reduces SeaStar helm protrusion from the front by the thickness of the dash and allows clean retrofit of SeaStar helm where following helms were previously installed: pre-1991 SeaStar, SyTen, or mechanical rotary steering. (Not for BayStar.)

The 20° Dash Mounting Wedge Kit (HA5419) allows a SeaStar helm to be mounted 20° from perpendicular in any or four configurations. (Not for BayStar.)

Tilt Steering:

Tilt Steering is offered as an option for all hydraulic steering systems except Hynautic and Capilano. Sport Tilt and Traditional Tilt Steering models are available for SeaStar and SeaStar PRO helms. When ordering hydraulic Tilt Steering, please note that the Tilt helm includes the tilt mechanism.

Please also see the "Dimensions" section for more information.

SEASTAR FRONT MOUNT HELM (mounts on front of dash)

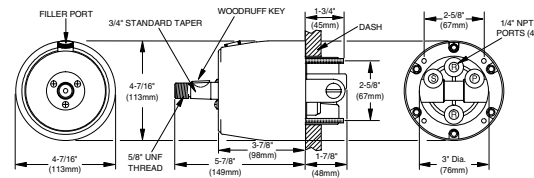

SEASTAR REAR MOUNT HELM (mounts behind dash)

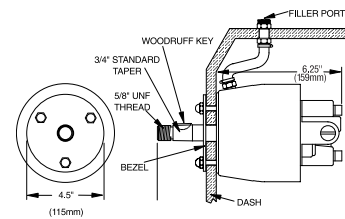

SEASTAR HELM MOUNTING KITS:

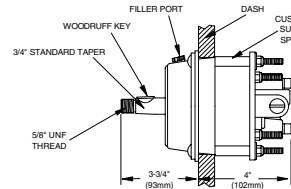

HA5417 ROUND BEZEL KIT

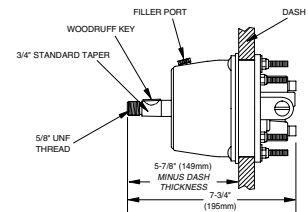

HA5418 BACK PLATE KIT

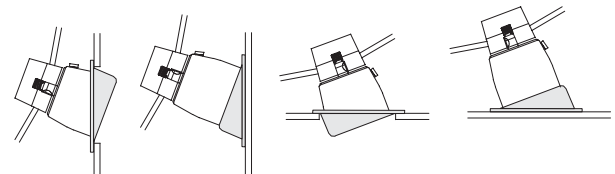

HA5419 20° DASH WEDGE KIT

TILT STEERING HELMS (include tilt mechanism & helm)

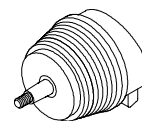

SPORT TILT (available for all SeaStar systems except Capilano & Hynautic)

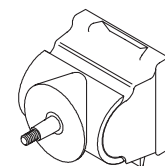

TRADITIONAL TILT (available for all SeaStar 1.7, 2.4 & SeaStar PRO systems, not Capilano & Hynautic)

TILT HELM (typical)

