



REMOVAL & INSTALLATION OF SEASTAR POWER ASSIST MOTOR Power Pump Part #799051

⚠ WARNING

The following procedures will require the Power Assist Unit to be disconnected/connected to and from the battery. It is suggested that the area where the battery and the Power Assist are located be completely **VENTED** and free of any fumes to avoid a potential fire.

Old Motor Removal

⚠ WARNING

If motor is **HOT**, allow sufficient time for it to cool prior to attempting to remove the motor.

1. After allowing sufficient venting time, disconnect the 2 Power Assist Terminals from the battery.
2. In most cases there is no need to remove any steering lines during the removal and/or installation of a new motor, however, if the hoses need to be removed to gain access to the rear of the Power Assist then the system will need to be completely bled free of air once the installation is completed
3. Locate and remove the 6 screws holding the rear cover of the Power Assist (refer to figure A).
4. Locate the 2 motor leads as shown in figure A1 and remove them completely from their points.
5. Unscrew wire coupling as shown in figure A2 and pull the wires out of the Power Assist.
6. Remove motor from the Power Assist valve body, being sure not to misplace the 2 x O-Rings and the coupling that are attached to the bottom of the motor.

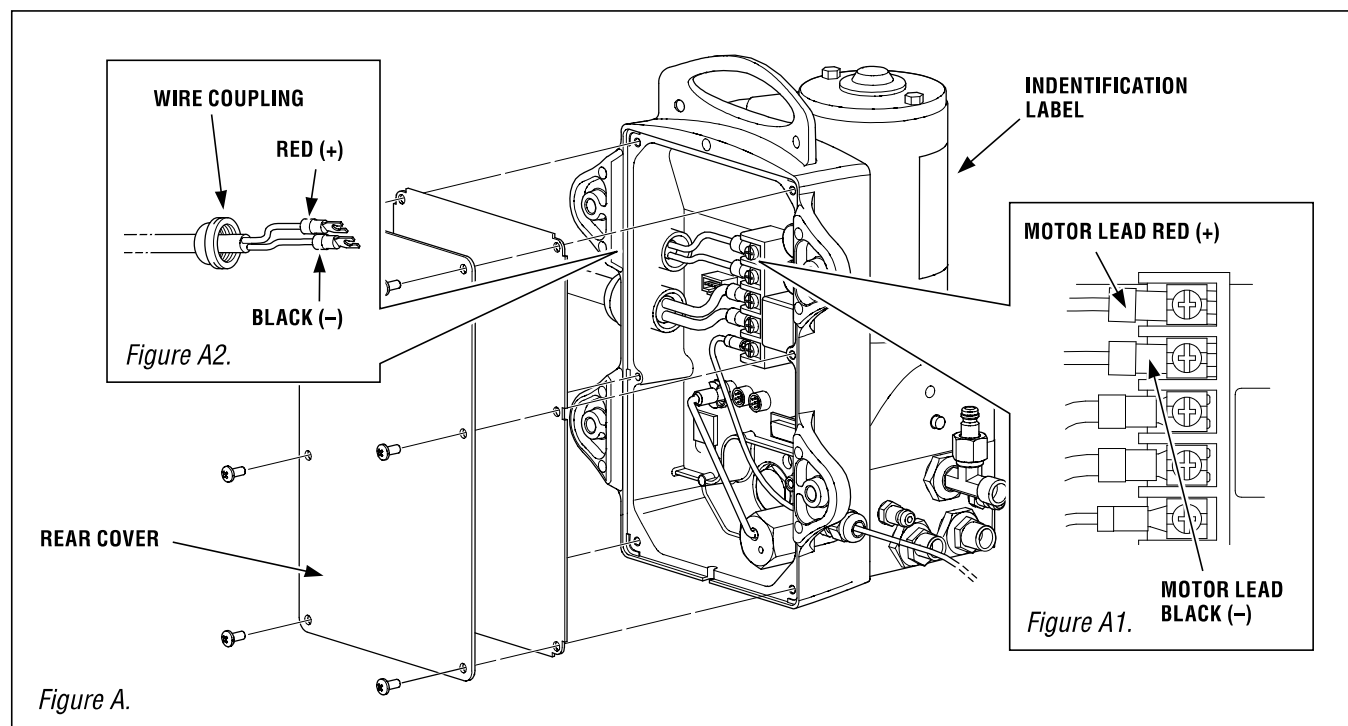



REMOVAL & INSTALLATION OF SEASTAR POWER ASSIST MOTOR Power Pump Part #799051

Installation of new fittings

1. Confirm that the 2 x O-Rings are installed on the new motor prior to installation.
2. Position the new motor so that the identifying label is positioned towards the outside.
3. Line-Up the motor shaft to match the same position of the coupling located in the valve body, ensure that the new motor is correctly seated in place.

NOTICE

Seating the motor incorrectly will cause the Power Assist Unit to malfunction.

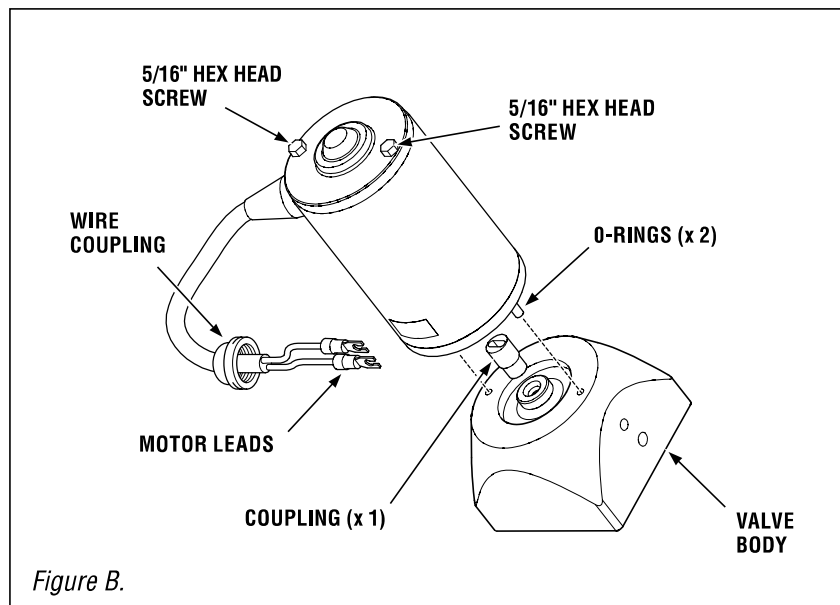

Figure B.

NOTICE

If hoses had to be removed to gain access to the rear portion of the Power Assist Unit, you will be required to bleed the system free of air prior to operating your boat. Please consult your Power Assist Owner's Manual for these details.

4. Tighten the 2 x 5/16" Hex Head bolts and torque to 14 in.lb, MAX.
5. Slide the wire coupling back onto the motor leads and run the motor leads into the rear of the Power Assist Unit.
6. Connect the Red (+) lead to the top connection and the Black (-) lead to the connection second from the top (refer to figure A1). Torque both leads to 2 in.lb.
7. Tighten wire coupling to the Power Assist Unit and torque to 4 in-lb.
8. Reinstall rear cover to the Power Assist Unit and torque each screw to 10 in-lb.
9. Reconnect Power Assist Unit leads to the correct terminals on the battery. Turn ignition **ON** and check the Power Assist Unit for any error codes.